

POTMETER MONO LIN 47K WITH SWITCH – K047AMS

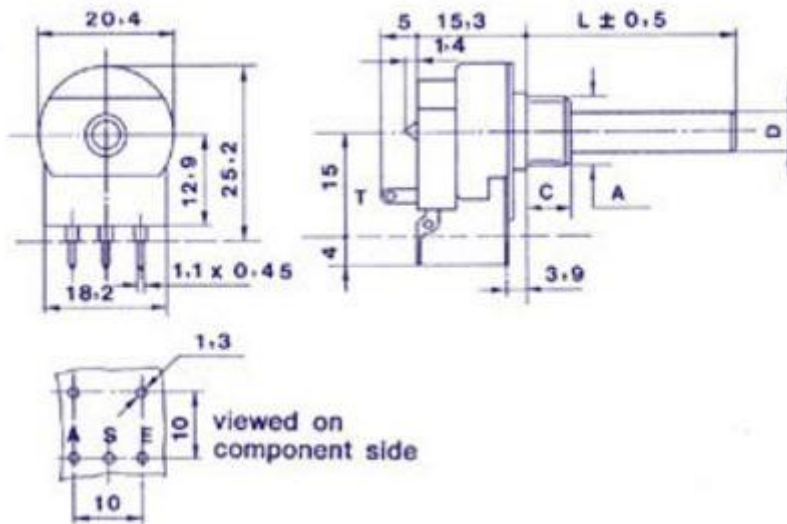

20mm rotary carbon track potentiometers for PCB mounting. Metal/plastic housing and plastic axle (Ø 6mm). Optional single-pole switch (1A-24Vdc / 0.3A-250Vac).

Features

- linear (A-series)
- mono
- switch
- OMEG

Specifications

- resistance range: 100E to 4M7 (E3-series)
- max. power dissipation: 0.4W
- tolerance: $\pm 20\%$
- max. working voltage: 500Vdc
- temperature range: -10°C to $+70^{\circ}\text{C}$
- electrical rotation: $300^{\circ} \pm 5^{\circ}$