

SERIES 1810 / 1820 - SINGLE POLE AND DOUBLE POLE TOGGLE

SWITCHES UP TO 10 (4) A 250 V~

STANDARD VERSION 1810

single pole and double pole



single pole

X = panel thickness



X	Y	Z
0.75...1.25	19.2 ^{-0.1}	12.9 ^{+0.1}
1.25...2	19.4 ^{-0.1}	12.9 ^{+0.1}
2 ...3	19.8 ^{-0.1}	12.9 ^{+0.1}

double pole

X = panel thickness

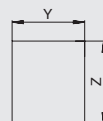

X	Y	Z
0.75...1.25	19.2 ^{-0.1}	21.9 ^{+0.1}
1.25...2	19.4 ^{-0.1}	21.9 ^{+0.1}
2 ...3	19.8 ^{-0.1}	21.9 ^{+0.1}

STANDARD VERSION 1820

single pole and double pole

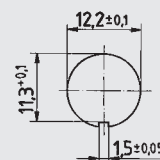

Electrical rating		10 (4) A 250 V~ 6 (4) A 250 V~ 5E4 6 A 125 - 250 V AC 1/4 HP 125 V AC 1/2 HP 250 V AC
Mechanical life endurance	ST/DT	1E5
	DT with centre-OFF	5E4
Contact resistance (new state)		< 100 mΩ (12 V, 1A DC)
Insulation resistance (new state)		> 100 MΩ (500 V DC between the open contacts)
High voltage resistance (new state)	< 3 mm ≥ 3 mm	750 V eff. (between the open contacts) 1250 V eff. (reinforced insulation) 3750 V eff. (reinforced insulation)
Resistance to tracking		PTI 250
Contact gap		≥ 3 mm
Insulation spacing		≥ 8 mm
Protection type		IP 40
Ambient temperature	terminal side actuating side	-20 °C ... +100 °C no condensation -20 °C ... + 55 °C no condensation
Storage temperature		-40 °C ... +80 °C
Flammability toggle and housing		UL 94 V-2
Heat and fire-resistance		850 °C (category D)
Material toggle and housing		PA
Contacts		Ag
Terminals		silver-plated
Temperature rise at the terminals (according to electrical life endurance)		max. 30 K (UL 1054) max. 55 K (EN 61058-1)
Push-on force of connectors		≤ 80 N
Approval marks		
Suitable for appliances of protection class II		

The test conditions comply with EN 61058-1 and UL 1054

ST-SWITCHES SERIES 1820

6 (4) A 250 V~ 5E4
 T 100/55
 6 A (1/4 HP) 125 V AC
 6 A (1/2 HP) 250 V AC



single pole
 □ 1821.1101*
 □ 1821.0101*

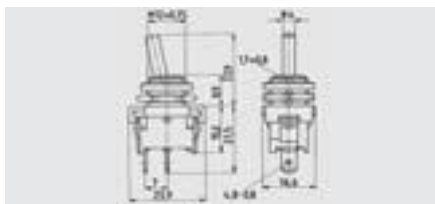

□ quick-connect terminal 4.8



double pole
 □ 1822.1101*
 □ 1822.0101*

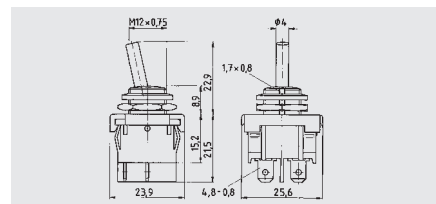

□ quick-connect terminal 4.8

ST-SWITCHES SERIES 1810

10 (4) A 250 V~
 6 (4) A 250 V~ 5E4
 T 100/55
 6 A (1/4 HP) 125 V AC
 6 A (1/2 HP) 250 V AC

Switches with and -approval marks for 10 A on request.



single pole
 □ 1811.1102*

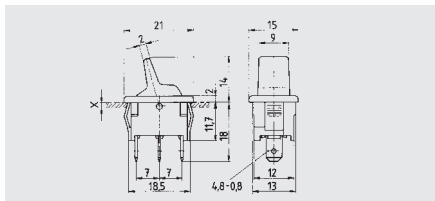

□ quick-connect terminal 4.8



double pole
 □ 1812.1102*

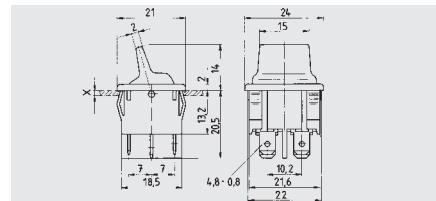

□ quick-connect terminal 4.8

DT-SWITCHES SERIES 1820

6 (4) A 250 V~ 5E4
 T 100/55



single pole
 □ 1823.1101*
 □ 1823.0101*

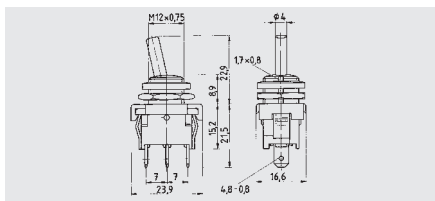

□ quick-connect terminal 4.8



double pole
 □ 1824.1101*
 □ 1824.0101

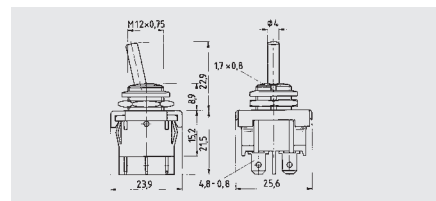

□ quick-connect terminal 4.8

* Version on stock