

RoHS Compliant

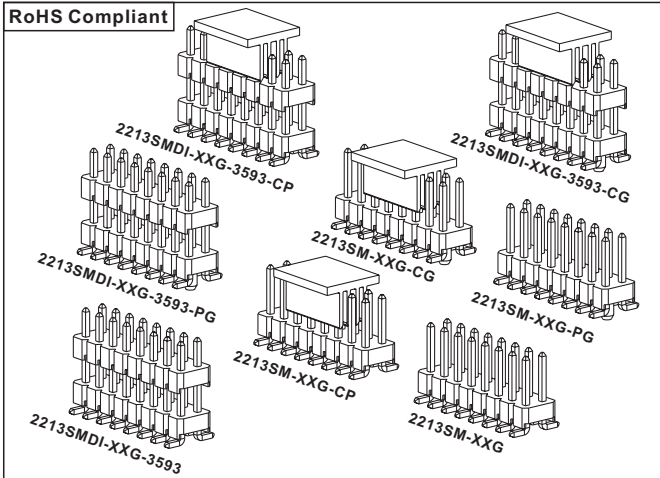

Specifications

1. Current Rating: 3.0A AC/DC.
2. Voltage Rating: 250V AC/DC.
3. Contact Resistance: 20m ohm. max.
4. Insulation Resistance: 1000M ohm. Min.
5. Withstanding Voltage: 600V AC for one minute.
6. Operating Temperature Range: -40°C to +105°C.

Material and Finish

1. Insulator: High Temp Plastic (Nylon6T UL94V-0).
2. Insulator Height: 1.50/1.70/2.00/2.54/3.00mm, (Detail Spec, Consult to Sales dept).
3. Contact: Copper Alloy.
4. Plating: Gold Plated.

Feature

1. Design for Home Appliances, Aviation Electronics, Automobile Electronics and Computer(PC) Peripherals.

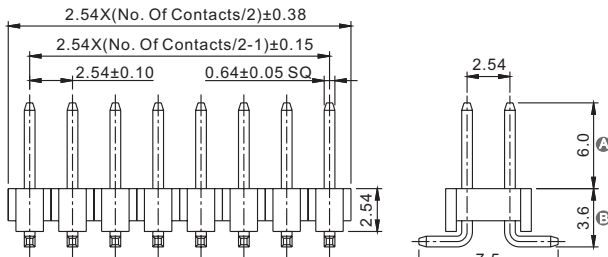

P/N: 2213SM-XXG

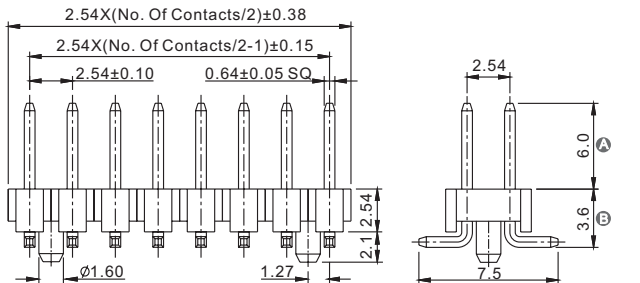

P/N: 2213SM-XXG-PG

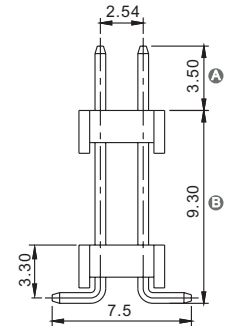
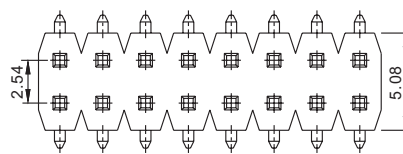

P/N: 2213SM(XG)-3593

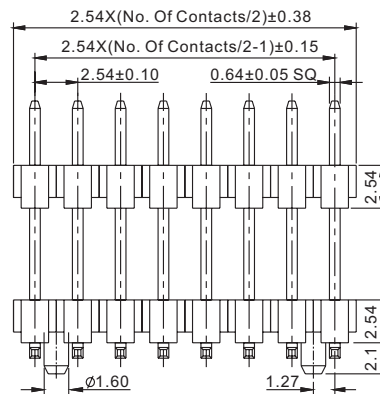

P/N: 2213SM(XG)-3593-PG

A/B Dimension To Be Advised By Value Customers

Ordering Information

2213SM-XXG-XXXX-PG

① ② ③ ④ ⑤

① SM: SMD Type	③ G: Gold Plated T: Tin Plated	④ Blank: Standard Type XXXX: Special Length A/B Dimension	⑤ Blank: Standard Type PG: With Post CP: With Cap CG: With Post and Cap
② No. Of Contacts (4 To 80 Ways)			

2213SMDI-XXG-XXXX-PG

① ② ③ ④ ⑤ ⑥

① SM: SMD Type	③ No. Of Contacts (4 To 80 Ways)	⑤ Blank: Standard Type XXXX: Special Length A/B Dimension	⑥ Blank: Standard Type PG: With Post CP: With Cap CG: With Post and Cap
② DI: Double Insulator	④ G: Gold Plated T: Tin Plated		

Recommended PCB Layout

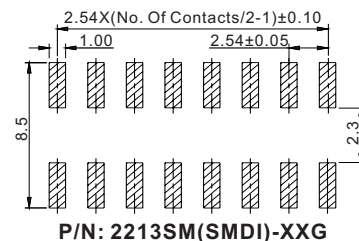

P/N: 2213SM(SMDI)-XXG

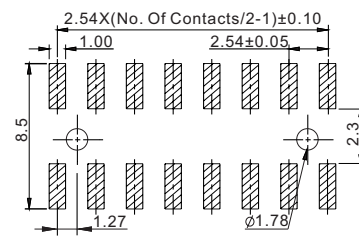

P/N: 2213SM(SMDI)-XXG-PG

Unit:mm