



Item No. : YFR25P

RoHS : RoHS

Description :

D-sub screw lock type
right angle 25-pin L=8.1mm

YFRxxP
L Pins

Part No.	A	B	C	D
YFR09P	30.81	24.99	16.92	11.08
YFR15P	39.14	33.32	25.25	19.39
YFR25P	53.04	47.04	38.96	33.24

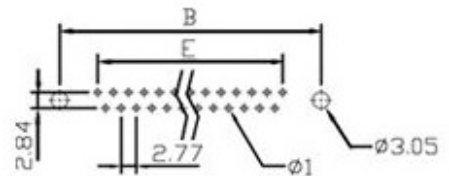
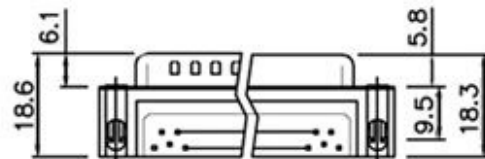
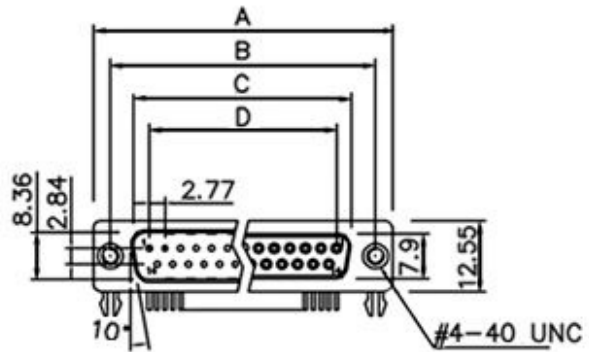

RECOMMENDED PCB LAYOUT

Specifications

- Current rating: 1A Max.
- Contact resistance: 30mΩ Max.
- Insulation resistance: 1000MΩ Min.
- Dielectric withstanding voltage: 750VAC for 1 minute
- Total mating force: 7.0 Kgf Max.
- Total unmating force: 1.5 Kgf Min.
- Temperature range: -55°C ~ 85°C

Materials

- Insulator: High temperature thermoplastic with G.F, UL94V-0
- Contact: Copper alloy, t=0.2mm
- Shell: Spcc, t=0.3mm

