

RoHS Compliant

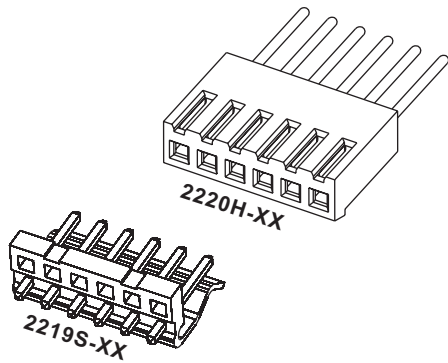

**Specifications**

Current rating: 7.0A AC/DC  
Voltage rating: 250V AC/DC  
Contact resistance: 10m ohm. max.  
Insulation resistance: 1000M ohm. Min.  
Withstanding voltage: 1500V AC for one minute  
Operating temperature range: -40°C to +105°C  
Application Wire: AGW 18 to 22

**Material and Finish**

A. Housing Insulator: Nylon66(UL94V-2)  
B. Crimp Terminal: Phosphor Bronze or Brass Tin Plated  
C. Wafer Insulator: Nylon66(UL94V-2)  
Contact Pin: Brass Alloys Tin Plated

**Connection**

2220H Mates With 2219S(R)(RR)-XX 2219S(R)-XX-01

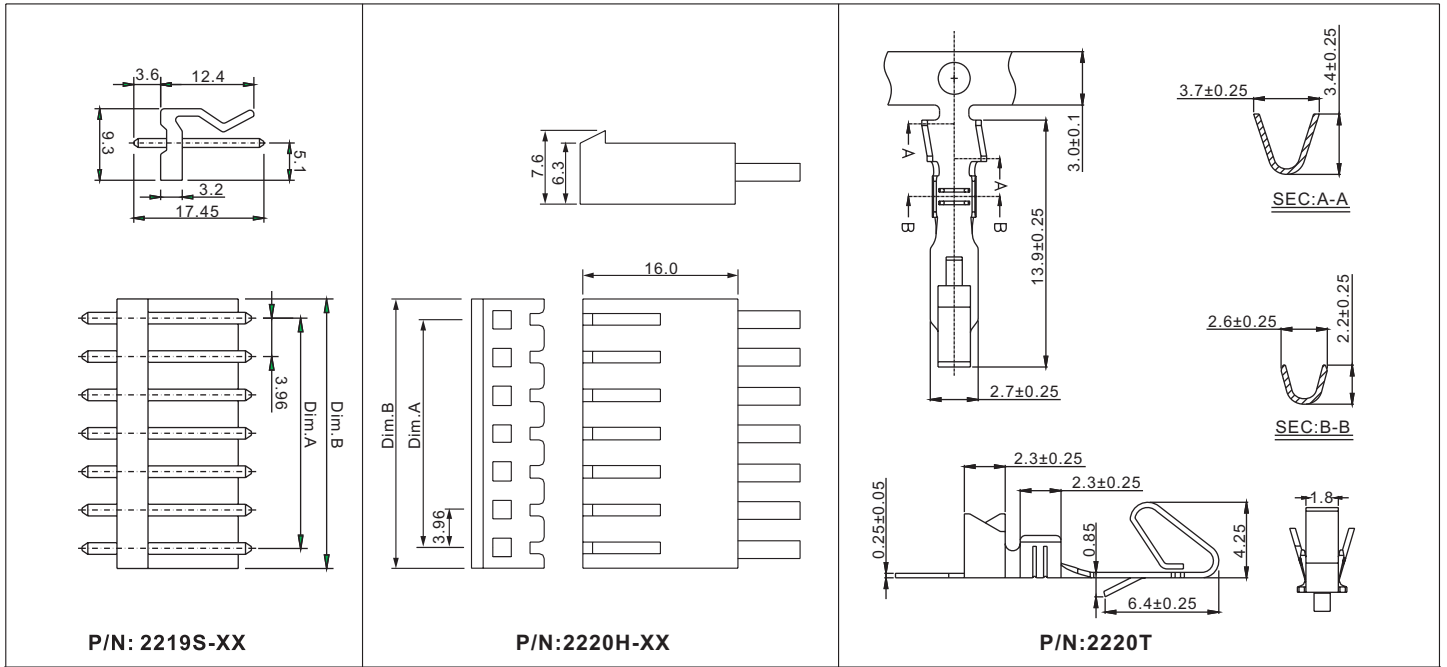

**Engineering Dimension**

P/N: 2219S-XX

Circuits	Dim. A	Dim. B	Circuits	Dim. A	Dim. B
2	3.96	7.92	12	43.56	47.52
3	7.92	11.88	13	47.52	51.48
4	11.88	15.84	14	51.48	55.44
5	15.84	19.80	15	55.44	59.40
6	19.80	23.76	16	59.40	63.36
7	23.76	27.72	17	63.36	67.32
8	27.72	31.68	18	67.32	71.28
9	31.68	35.64	19	71.28	75.24
10	35.64	39.60	20	75.24	79.20
11	39.60	43.56			

**Ordering Information**

**2220H-XX**

① ②

① H: Housing	② No. Of Contacts
--------------	-------------------

**2219S-XX**

① ②

① S: Straight Type	② No. Of Contacts
--------------------	-------------------

**Recommended PCB Layout**

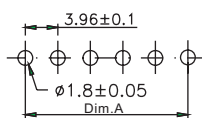

P/N: 2219S-XX

Unit:mm