



Item No. : K3162

RoHS : RoHS

Description :

din plug metal type 180°

K3162 x
└ Pole

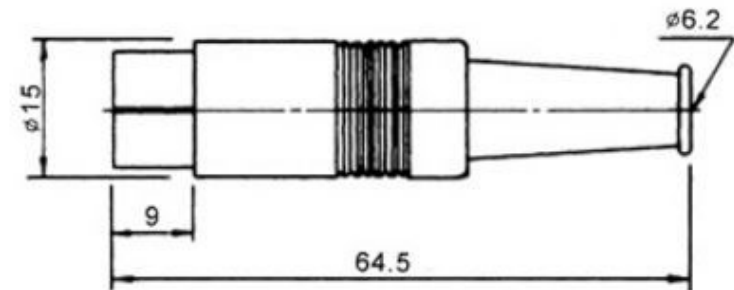
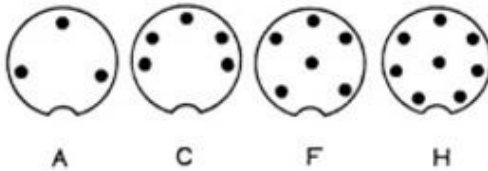

Specifications

Contact resistance: 30m Ω max. (initial)
Insulation resistance: 50M Ω min. at 250V DC
Withstanding voltage: 250V AC for one minute
Insertion force: 5.0 kg
Extraction force: 4.0 kg
Life time: 5,000 cycles min