

Machine Pin Socket Straight Type 2.54mm

Specifications

Current Rate: 3 AMP
 Insulation Resistance: $\geq 1000M\Omega$ at $V=100V$.
 Contact Resistance: $\leq 4m\Omega$ /Contact.
 Dielectric Voltage: 1000V AC for one minute
 Operation Temperature: $-40^{\circ}C$ to $+105^{\circ}C$

Material

Insulator: Polyester, UL 94V-0
 ©Standard: PPS
 Terminal: Copper Alloy
 Plated: Selective Plated

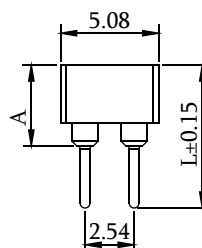
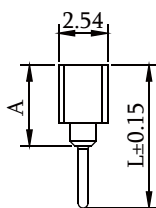
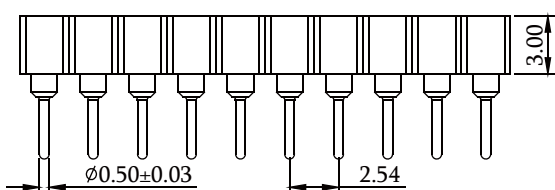
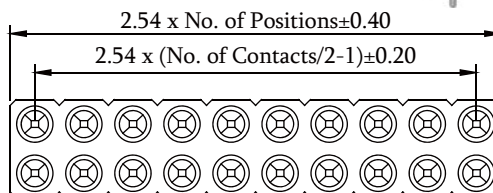
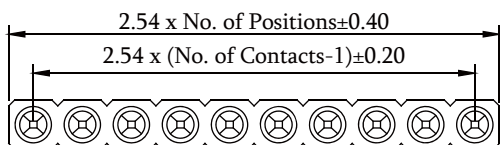
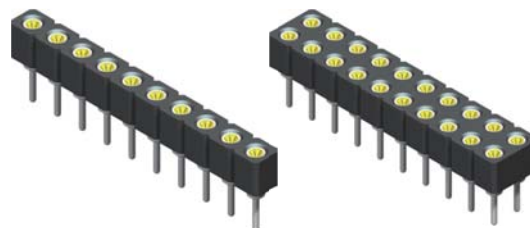

Code	Dim. A	Dim. L
740	4.20	7.40
840	4.20	8.40

Part No.: MS1S-1/2XX-U

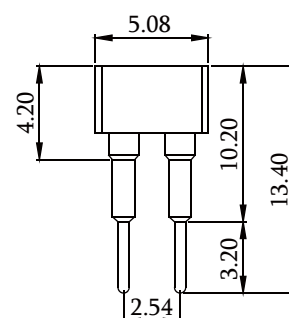
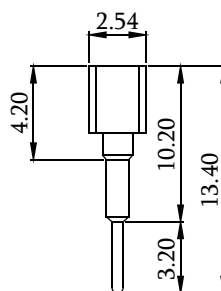
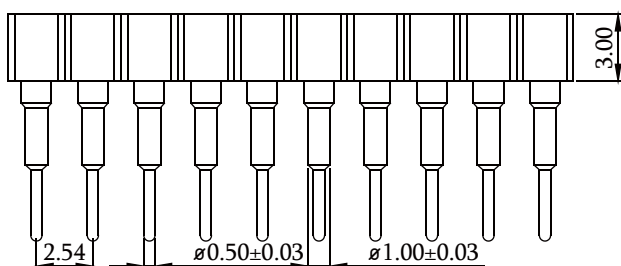
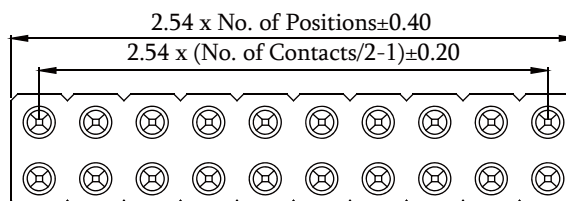
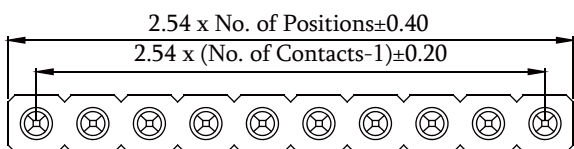

Part No.: MS1S-1/2XX-1340A-U

ORDER INFORMATION

