

PLASTIC:

MATERIAL: ABS HIGH TEMP. PLASTIC, 94HB
 PLATING: NONE
 OPERATING TEMP.: -35°C TO +85°C

METALIZED PLASTIC:

MATERIAL: ABS HIGH TEMP. PLASTIC, 94HB
 PLATING: NICKEL OVER COPPER
 OPERATING TEMP.: -35°C TO +85°C

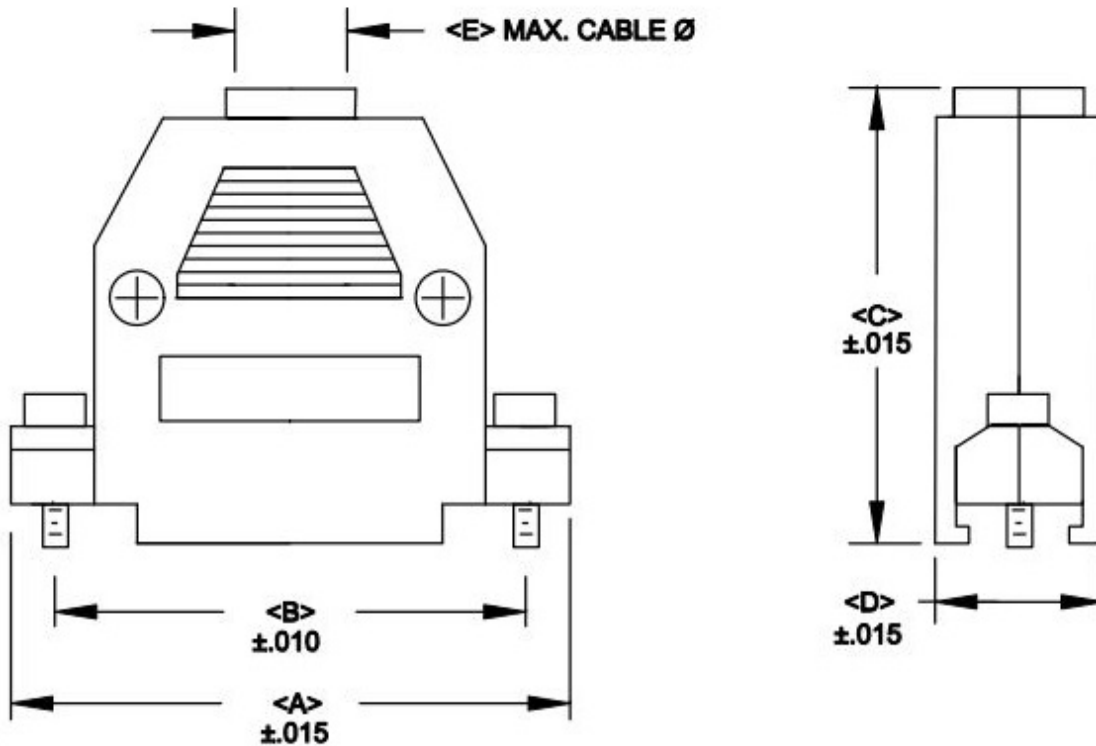

POSITION:	A	B	C	D	E
9	1.213	.984	1.594	.646	.275
	30.81	24.99	40.49	16.41	6.99
15	1.563	1.312	1.453	.646	.400
	39.70	33.32	36.91	16.41	10.16
25	2.165	1.852	1.752	.646	.435
	54.99	47.04	44.50	16.41	11.05
37	2.736	2.500	2.096	.984	.535
	69.49	62.50	53.24	24.99	13.59