



Item No. : M5634

RoHS : RoHS

Description :

F female bulkhead

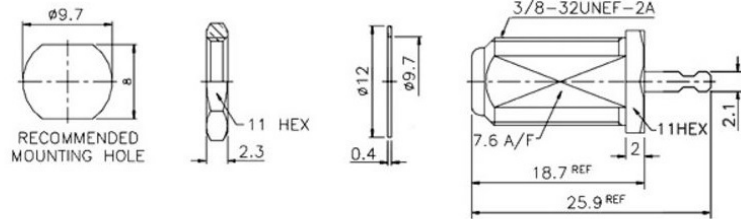

Electrical Specifications

Connector series	Impedance	Frequency range	Voltage rating	Withstanding voltage	Contact resistance	Insulation resistance
SMA	50Ω	0 - 18 GHz	AC 500V	AC1000V one minute	3.0mΩ max	5000MΩ min at DC 500V
SSMA	50Ω	0 - 18 GHz	AC 250V	AC 750V one minute	4.0mΩ max	1000MΩ min at DC 500V
QMA	50Ω	0 - 6 GHz	AC 335V	AC1000V one minute	3.0mΩ max	5000MΩ min at DC 500V
SMB	50Ω	0 - 4 GHz	AC 250V	AC 750V one minute	6.0mΩ max	1000MΩ min at DC 500V
SSMB	50Ω	0 - 4 GHz	AC 250V	AC 500V one minute	4.0mΩ max	1000MΩ min at DC 500V
SMC	50Ω	0 - 10 GHz	AC 335V	AC 750V one minute	6.0mΩ max	1000MΩ min at DC 500V
SMP	50Ω	0 - 40 GHz	AC 350V	AC 500V one minute	6.0mΩ max	5000MΩ min at DC 500V
MCX	50Ω	0 - 6 GHz	AC 335V	AC1000V one minute	5.0mΩ max	1000MΩ min at DC 500V
MMCX	50Ω	0 - 6 GHz	AC 170V	AC 500V one minute	5.0mΩ max	1000MΩ min at DC 500V
UHF	50Ω	0 - 300 MHz	AC 500V	AC1500V one minute	3.0mΩ max	5000MΩ min at DC 500V
MINI UHF	50Ω	0 - 2.5GHz	AC 335V	AC1000V one minute	5.0mΩ max	5000MΩ min at DC 500V
BNC	50Ω/75Ω	0-4/0-1GHz	AC 500V	AC1500V one minute	3.0mΩ max	5000MΩ min at DC 500V
MINI BNC	75Ω	0 - 2 GHz	AC 300V	AC1000V one minute	1.2mΩ max	1000MΩ min at DC 500V
F	75Ω	0 - 2 GHz	AC 250V	AC 500V one minute	5.0mΩ max	1000MΩ min at DC 500V
N	50Ω	0 - 11 GHz	AC1000V	AC2500V one minute	3.0mΩ max	5000MΩ min at DC 500V
TNC	50Ω/75Ω	0-4/0-1 GHz	AC 500V	AC1500V one minute	3.0mΩ max	5000MΩ min at DC 500V
FME	50Ω	0 - 3 GHz	AC 500V	AC1000V one minute	10 mΩ max	5000MΩ min at DC 500V
TWINAXIAL	78Ω, 95Ω	0 - 200 MHz	AC 500V	AC1500V one minute	4.0mΩ max	5000MΩ min at DC 500V
TWIN-BNC	NON-CONSTANT	0 - 100 MHz	AC 100V	AC1500V one minute	2.5mΩ max	5000MΩ min at DC 500V
1.0/2.3 COAXIAL	50Ω	0 - 4 GHz	AC 250V	AC 750V one minute	6.0mΩ max	1000MΩ min at DC 500V
1.6/5.6 COAXIAL	75Ω	0 - 1 GHz	AC 335V	AC1000V one minute	4.0mΩ max	1000MΩ min at DC 500V
7 / 16 COAXIAL	50Ω	0 - 7.5 GHz	AC2700V	AC4000V one minute	1.5mΩ max	5000MΩ min at DC 500V
BT43	75Ω	0 - 3 GHz	AC 500V	AC1500V one minute	5.0mΩ max	5000MΩ min at DC 500V