

## YGM - serie D-Subminiature Connectors

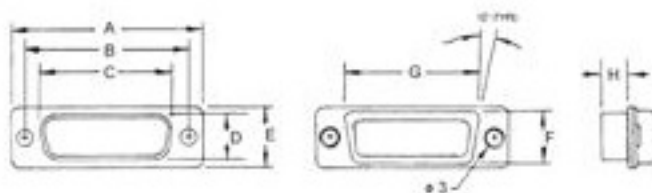

Shell size	A	B	C	D	E	F	G	H
9 - plug	30.8	25.0	17.70	9.14	12.6	10.72	19.30	6.0
9 - socket	30.8	25.0	16.26	7.82	12.6	10.72	19.30	5.8
15 - plug	39.1	33.3	26.04	9.14	12.6	10.72	27.50	6.0
15 - socket	39.1	33.3	24.60	7.82	12.6	10.72	27.50	5.8
25 - plug	53.0	47.0	40.21	9.60	12.6	10.72	41.30	6.0
25 - socket	53.0	47.0	38.30	7.82	12.6	10.72	41.30	5.8
37 - plug	69.3	63.5	56.67	9.60	12.6	10.72	57.70	6.0
37 - socket	69.3	63.5	54.76	7.82	12.6	10.72	57.70	5.8
50 - plug	66.9	61.1	54.03	12.29	15.4	13.56	55.32	6.0
50 - socket	66.9	61.1	52.34	10.67	15.4	13.56	55.32	5.8



Plug : (YGMxxP)  
 Socket : (YGMxxS)  
 No. of pins —┘  
 (9,15,25,37 pins available)